

OFFERING MEMORANDUM

STAND-ALONE MEDICAL

ACROSS THE STREET FROM
PEACEHEALTH ST. JOSEPH

3010 SQUALICUM PARKWAY
BELLINGHAM, WA



GREG MARTINEAU, CCIM
BROKER/ OWNER
GREG@GAGECRE.COM
(360) 820-4645

TRACY CARPENTER
BROKER/ OWNER
TRACY@GAGECRE.COM
(360) 303-2608



WWW.GAGECRE.COM

IMPORTANT DISCLOSURES

This Offering Memorandum (the "Memorandum") has been prepared by Gage Commercial Real Estate, LLC for informational purposes only. The information contained herein is believed to be reliable, but no representation or warranty, express or implied, is made regarding its accuracy, completeness, or correctness. Prospective purchasers are encouraged to conduct their own due diligence and consult with their advisors before making any investment decision.

This Memorandum is not an offer to sell or a solicitation of an offer to buy any securities or interests in the property. Any offering or solicitation will be made only to qualified prospective purchasers pursuant to applicable laws and regulations. The information contained in this Memorandum is confidential and is intended solely for the use of the recipient. It may not be reproduced or distributed, in whole or in part, without the prior written consent of Gage Commercial Real Estate, LLC.

Prospective purchasers should rely solely on their own investigation and evaluation of the property and any investment decision should be made based on the purchaser's own analysis. Gage Commercial Real Estate, LLC and its representatives make no representation or warranty, express or implied, as to the accuracy or completeness of the information contained herein.

By accepting this Memorandum, you agree to the above terms and conditions.

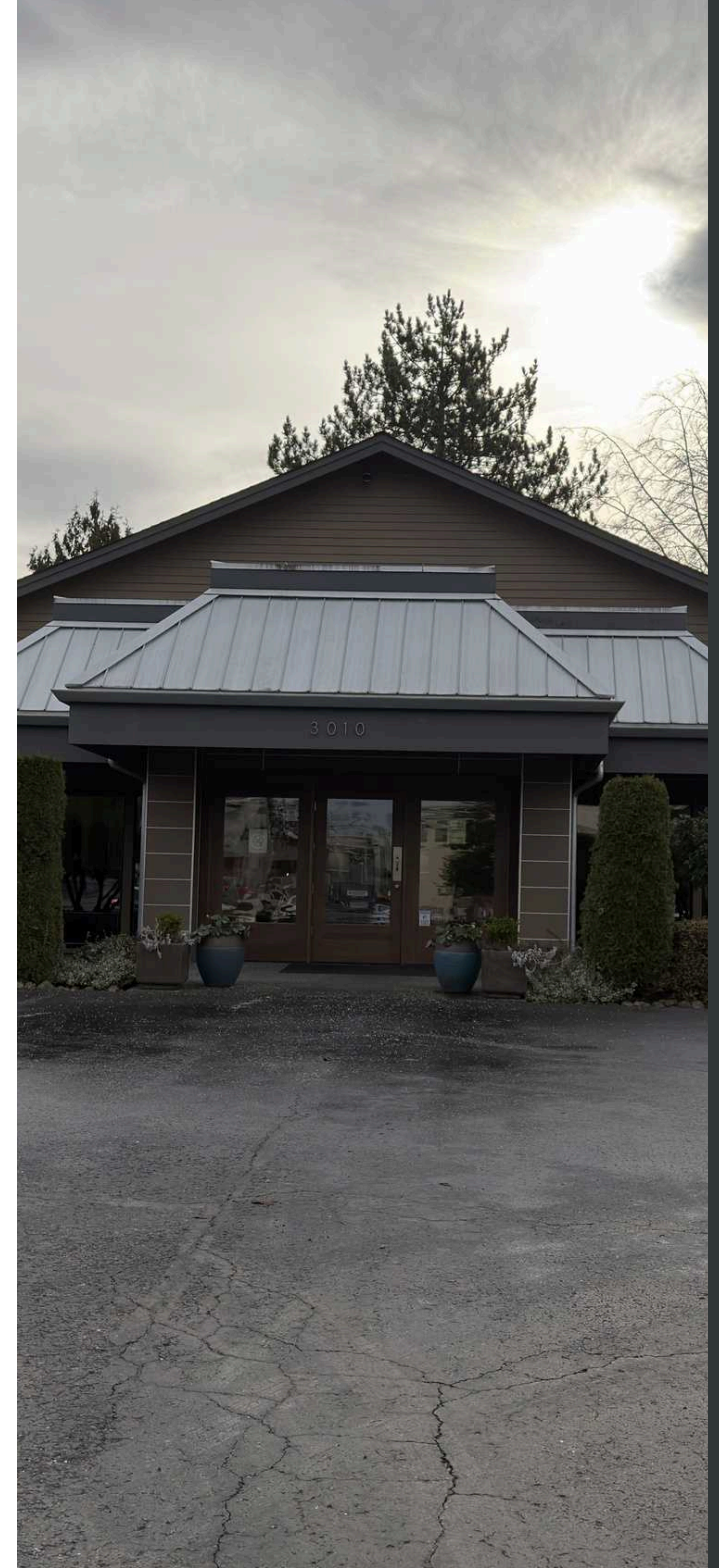

THE OFFERING

3,688 SF | STAND-ALONE MEDICAL

Business & Real Estate for Sale.

Incredibly well located medical office space directly across from St. Joseph's Hospital. Building built in 1987, with remodels in 2011 and 2015.

Building has been historically owner occupied, and maintained to high standard. Building has flexibility to support up to 4 physicians.

Includes 2 waiting areas, large nurses station, 4 physicians offices, 8 exam rooms, billing office, flex office (possibility for 9th exam room), 3 private restrooms, washer/ dryer, break room, and 3 exits to rear of building.

PROPERTY ADDRESS	3010 Squalicum Pkwy, Bellingham WA 98225
SQUARE FEET	3,688 SF
LOT SIZE	0.48 Ac. (20,820 SF)
PARCEL NUMBER	3803193954450000
ASKING PRICE	\$2,650,000

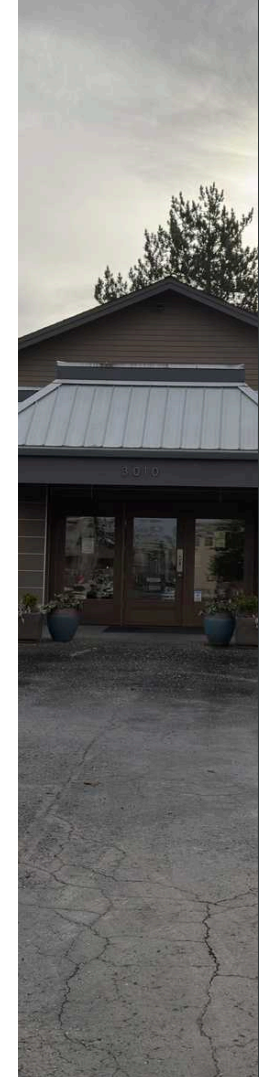
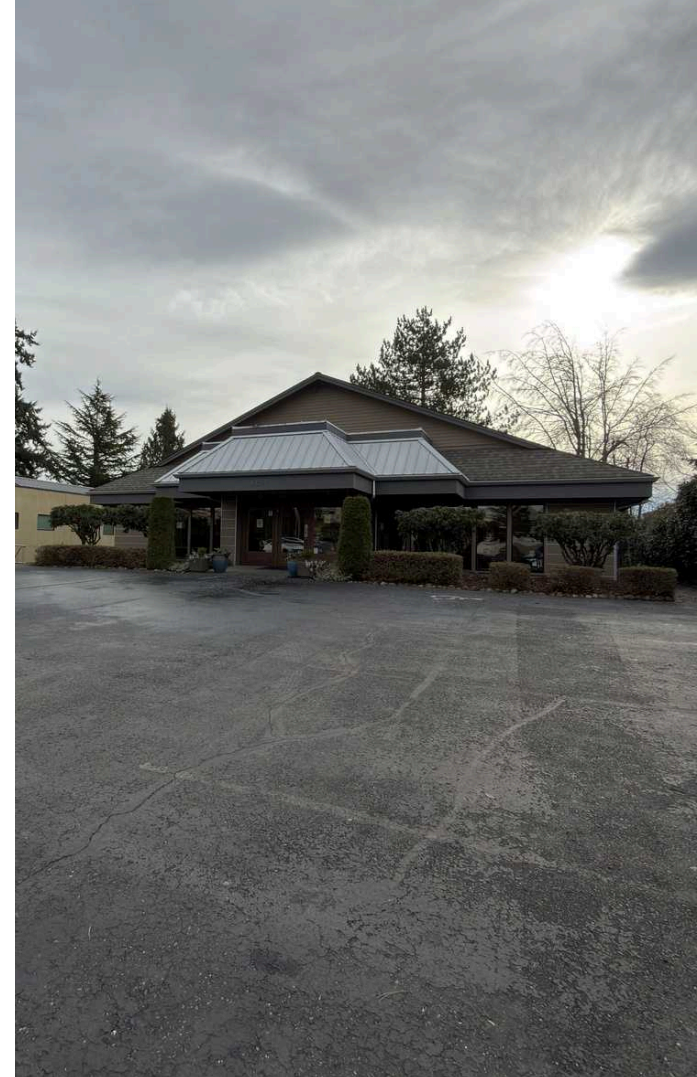



HIGHLIGHTS

- A+ Location, property located immediately across from Peacehealth St. Joesph
- 2 Reception/ waiting area
- 8 exam rooms
- 4 Physician's offices
- Large Nurses Station
- 3 Private restrooms
- Washer/ Dryer
- Breakroom
- Billing Office
- Flex Office (Possibility for 9th Exam Room)
- 3 rear exits
- Large parking lot with 21 parking spots and enclosed trash area.

*3rd exit point along west side of building currently serves as employee ingress/egress (further descried on floor plan below).

Office can be rented individually as an exam room and is additionally operational for telehealth services.

NEARBY AMENITIES

- 1 Peacehealth St Joseph Campus
- 2 Optum Health
- 3 PH OBGYN
- 4 Mt. Baker Imaging
- 5 Bellingham Ear Nose & Throat
- 6 Family Care Network
- 7 Mt Baker Kidney Center
- 8 Birchwood Medical Center
- 9 Family Care Network
- 10 Cascade Brain & Spine Center
- 11 Mt. Baker Vision Clinic
- 12 Bellingham Urology Group

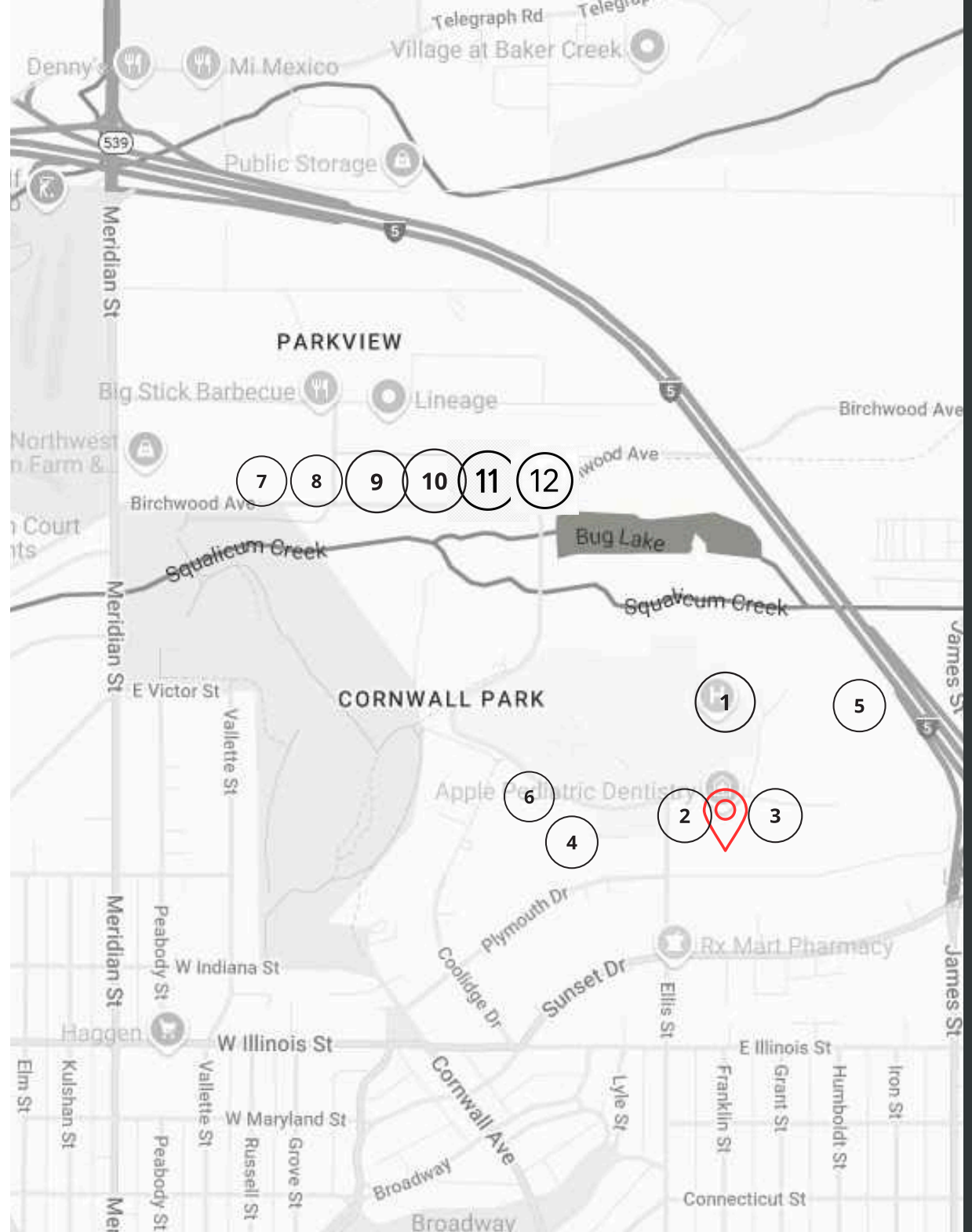

AERIAL



PeaceHealth

Squalicum Pkwy

Ellis St

3010 Squalicum Pkwy

FLOOR PLAN

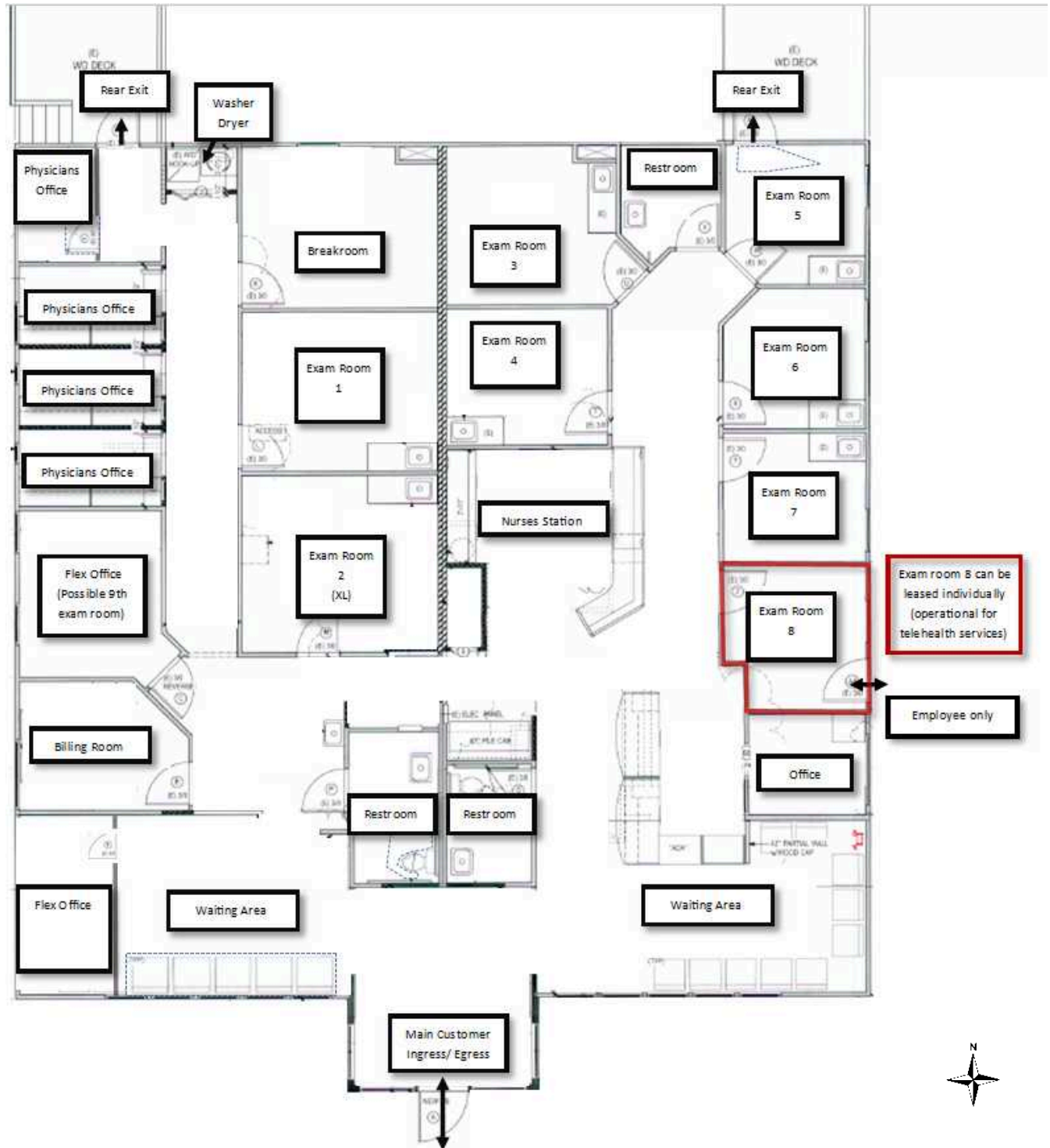



AREA OVERVIEW

BELLINGHAM, WA

On the shores of Bellingham Bay with Mount Baker as its backdrop, Bellingham is historically one of the Top 100 places to live in the Nation, and the last major city before the Washington coastline meets the Canadian border. The City of Bellingham, which serves as the county seat of Whatcom County, is at the center of a uniquely picturesque area offering a rich variety of recreational, cultural, educational and economic activities.

Quick Facts:

- Population: 90,620
- Area: 30.1 square miles
- Travel distances
- Canadian border: 21 miles
- Vancouver, B.C: 52 miles
- Seattle: 90 miles
- Miles of bike lanes: 61.1
- Miles of trails: 68.7





CONTACT

Greg Martineau, CCIM
Broker/ Owner
360-820-4645
Greg@gagecre.com

Tracy Carpenter
Broker/ Owner
360-303-2608
Tracy@gagecre.com



Gage Commercial Real Estate, LLC | 809 W Orchard Dr, Ste 7, Bellingham, WA |
360-483-0508 | greg@gagecre.com, tracy@gagecre.com
www.GageCRE.com