

LEGACY PROFESSIONAL PARK

OFFICE SPACES FOR LEASE | 3456 E 17TH ST | AMMON, ID 83406



CONTACT

NICK TERRY
208.357.4678
nickt@tokcommercial.com

HIGHLIGHTS

Single suites available: Flexible office spaces, perfect for a variety of business.

High-visibility location: Situated off of E 17th St, ensuring excellent exposure and accessibility.

Proximity to major retailers: Close to large retail stores, restaurants, and a variety of professional services.

Thriving business hub: Surrounded by a strong mix of office and business users.

DETAILS

| SPACE: | SIZE: | RATE: | AVAILABLE: |
|-----------|--------|--------------|-------------|
| Suite 295 | 172 SF | \$350.00/mo. | Immediately |

| | |
|--------------------|--------------------|
| BLDG. SIZE: | 9,117 SF |
| LEASE TYPE: | NNN |
| EST. NNN: | \$5.34 |
| ZONING: | Central Commercial |

UPDATED: 3.4.2026

THIS PROPERTY IS EXCLUSIVELY MARKETING BY TOK EASTERN IDAHO LLC DBA TOK COMMERCIAL

This information was obtained from sources believed reliable but cannot be guaranteed. Any opinions or estimates are used for example only.



AVAILABLE SPACE

| SPACE: | SIZE: | RATE: | AVAILABLE: |
|-----------|--------|--------------|-------------|
| Suite 295 | 172 SF | \$350.00/mo. | Immediately |

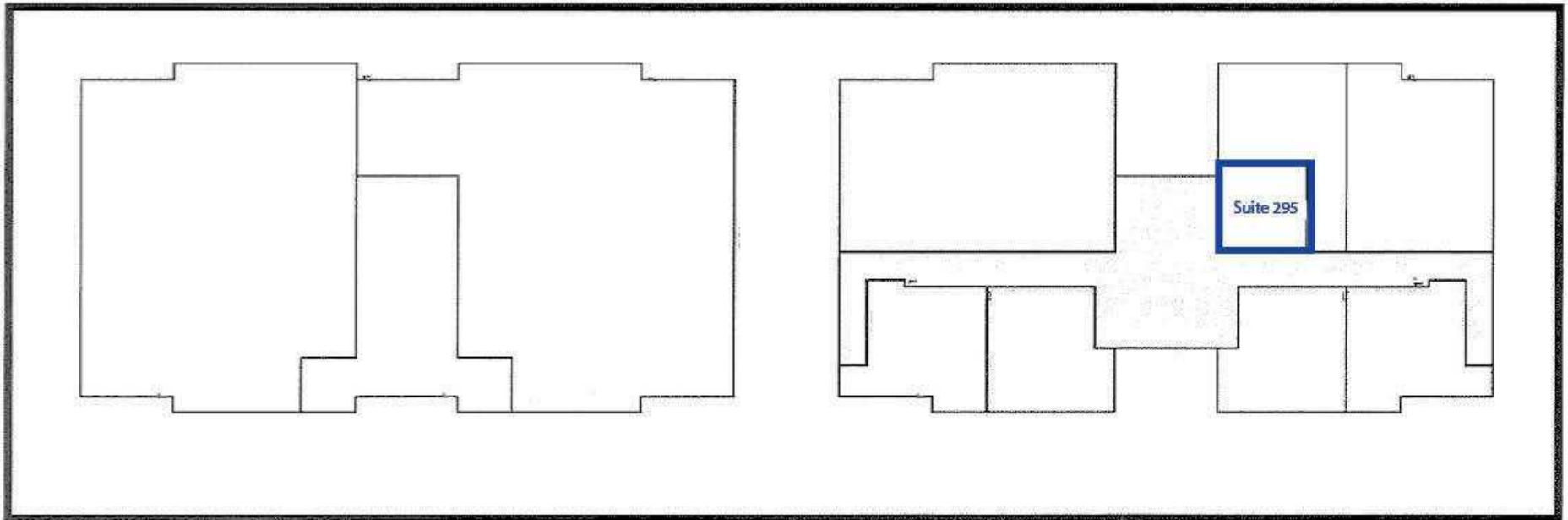

FLOOR PLAN

UPDATED: MARCH 04, 2026

THIS PROPERTY IS EXCLUSIVELY MARKETING BY TOK EASTERN IDAHO LLC DBA TOK COMMERCIAL

This information was obtained from sources believed reliable but cannot be guaranteed. Any opinions or estimates are used for example only.



UPDATED: MARCH 04, 2026

THIS PROPERTY IS EXCLUSIVELY MARKETED BY TOK EASTERN IDAHO LLC DBA TOK COMMERCIAL
This information was obtained from sources believed reliable but cannot be guaranteed. Any opinions or estimates are used for example only.



SANDCREEK COMMONS

Cabela's
petco
HOBBY LOBBY
Culver's
Wendy's
Broulim's
Orangetheory FITNESS

FIRMCMC
EASTERN IDAHO
REGIONAL MEDICAL CENTER
Mountain View
Hospital

GRAND TETON MALL

TARGET

HITTRD

17TH STREET

20,041 VPD

U-HAUL

17TH STREET

Walgreens

SITE

UPDATED: MARCH 04, 2026

THIS PROPERTY IS EXCLUSIVELY MARKETED BY TOK EASTERN IDAHO LLC DBA TOK COMMERCIAL
This information was obtained from sources believed reliable but cannot be guaranteed. Any opinions or estimates are used for example only.



UPDATED: MARCH 04, 2026

THIS PROPERTY IS EXCLUSIVELY MARKETED BY TOK EASTERN IDAHO LLC DBA TOK COMMERCIAL
This information was obtained from sources believed reliable but cannot be guaranteed. Any opinions or estimates are used for example only.