

# INCOME PRODUCING OWNER/USER OR INVESTMENT OPPORTUNITY FOR SALE OR LEASE

20 NEARING WAY, SMELTERVILLE, ID 83868



**KRIS JACKSON**

208.449.1696 / kris@tokcommercial.com

**TOK** COMMERCIAL  
REAL ESTATE

## FOR LEASE

AVAILABLE	BLDG SIZE	LEASE RATE
FORMER GROCERY OUTLET	18,000 SF	\$29,700/YR

## FOR SALE - FORMER GROCERY OUTLET

AVAILABLE	BLDG SIZE	LOT SIZE	SALE PRICE
FORMER GROCERY OUTLET	18,000 SF	2.14 AC	\$6,480,000

**\$356,400**

**5.5%**

NOI (POTENTIAL)

CAP RATE (POTENTIAL)

## FOR SALE - FORMER GROCERY OUTLET + JITTERZ

AVAILABLE	BLDG SIZE	LOT SIZE	SALE PRICE
FORMER GROCERY OUTLET	18,000 SF	2.14 AC	
JITTERZ (LEASED)	-	0.49 AC	
<b>TOTAL</b>	<b>-</b>	<b>2.63 AC</b>	<b>\$7,500,000</b>

**\$392,400**

**5.50%**

NOI (POTENTIAL)

CAP RATE (POTENTIAL)

# PROPERTY SUMMARY

Submarket	Silver Valley Retail
Zoning	Commercial
Property Type	Retail
Lot Size	2.63 Acres
Year Built	2022



## [ 2 ] FORMER GROCERY OUTLET

UPDATED: 5.21.2026

THIS PROPERTY IS EXCLUSIVELY MARKETED BY TOK BOISE LLC DBA TOK COMMERCIAL. THIS INFORMATION WAS OBTAINED FROM SOURCES BELIEVED RELIABLE BUT CANNOT BE GUARANTEED. ANY OPINIONS OR ESTIMATES ARE USED FOR EXAMPLE ONLY.

**TOK**COMMERCIAL.COM

# FINANCIAL SUMMARY

FULL  
OFFERING  
MEMORANDUM



CLICK HERE TO ACCESS 

[ 3 ] **FORMER GROCERY OUTLET**

UPDATED: 5.21.2026

THIS PROPERTY IS EXCLUSIVELY MARKETED BY TOK BOISE LLC DBA TOK COMMERCIAL. THIS INFORMATION WAS OBTAINED FROM SOURCES BELIEVED RELIABLE BUT CANNOT BE GUARANTEED. ANY OPINIONS OR ESTIMATES ARE USED FOR EXAMPLE ONLY.

**TOK**COMMERCIAL.COM

# THE HIGHLIGHTS



Available for sale or lease, providing flexibility for both investors and owner-users seeking a strategic retail opportunity



Former Grocery Outlet featuring an efficient 18,000 SF retail layout on 2.14 acres designed to support high customer traffic and operational flow



Property includes both dock-high and grade-level loading doors, allowing flexibility for retail, distribution, inventory management, and service-oriented uses



Site includes an existing drive-thru coffee component and offers strong potential for a future anchor tenant to drive additional customer traffic



Prime location with excellent visibility and direct access from I-90 at Exit 48, positioned within Silver Valley's established regional retail corridor alongside national retailers



# FLOOR PLAN

## FORMER GROCERY OUTLET

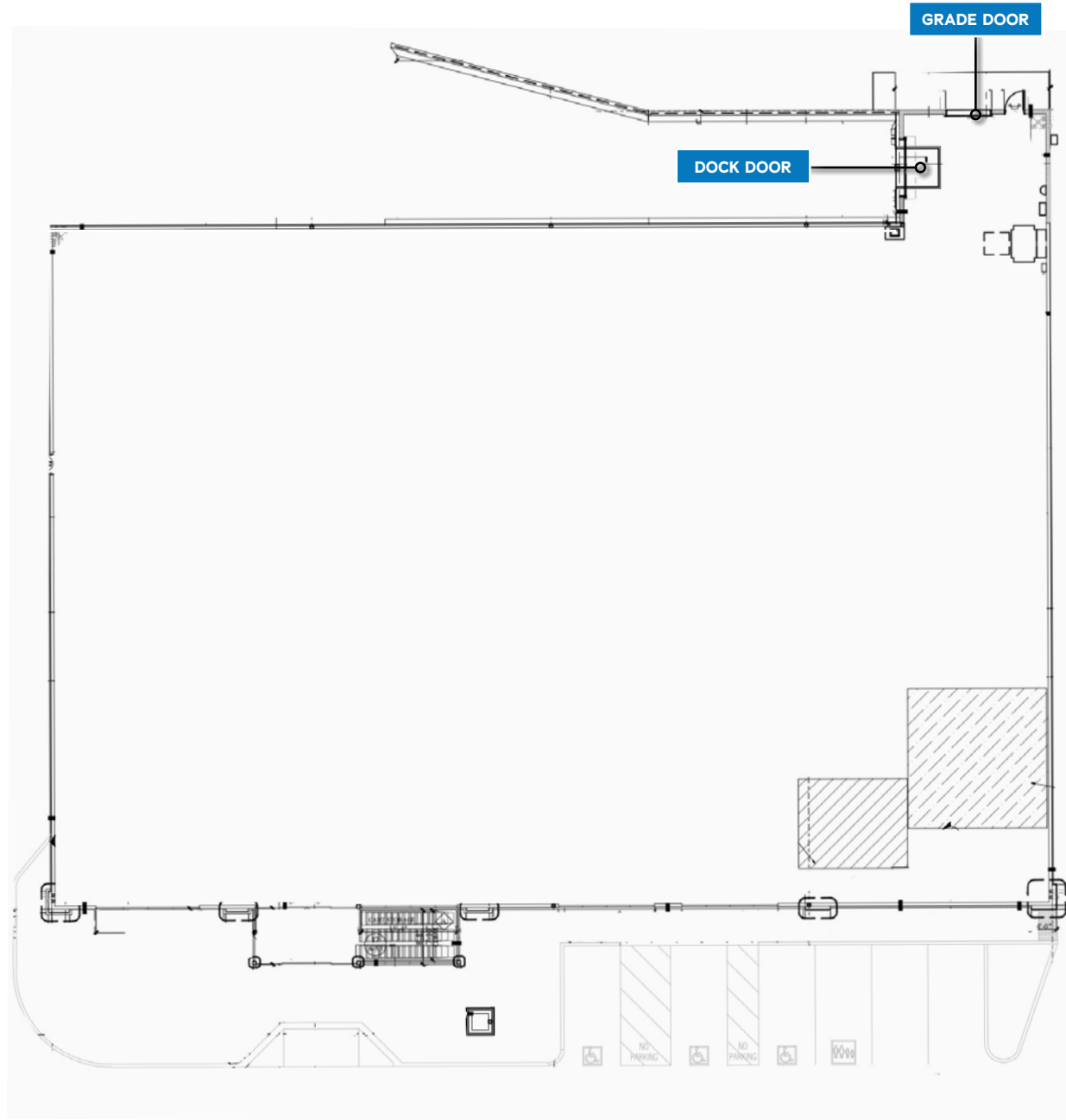





[ 7 ] **FORMER GROCERY OUTLET**

UPDATED: 5.21.2026

THIS PROPERTY IS EXCLUSIVELY MARKETED BY TOK BOISE LLC DBA TOK COMMERCIAL. THIS INFORMATION WAS OBTAINED FROM SOURCES BELIEVED RELIABLE BUT CANNOT BE GUARANTEED. ANY OPINIONS OR ESTIMATES ARE USED FOR EXAMPLE ONLY.



[ 8 ] **FORMER GROCERY OUTLET**

UPDATED: 5.21.2026 THIS PROPERTY IS EXCLUSIVELY MARKETED BY TOK BOISE LLC DBA TOK COMMERCIAL. THIS INFORMATION WAS OBTAINED FROM SOURCES BELIEVED RELIABLE BUT CANNOT BE GUARANTEED. ANY OPINIONS OR ESTIMATES ARE USED FOR EXAMPLE ONLY.

5 MILE RADIUS



POPULATION  
**6,973**  
1 MI. RADIUS



HOUSEHOLDS  
**2,968**  
1 MI. RADIUS



AVG. HOUSEHOLD INC.  
**\$72,959**  
1 MI. RADIUS

10 MILE RADIUS



POPULATION  
**10,439**  
3 MI. RADIUS



HOUSEHOLDS  
**4,503**  
3 MI. RADIUS



AVG. HOUSEHOLD INC.  
**\$70,775**  
3 MI. RADIUS

15 MILE RADIUS



POPULATION  
**13,600**  
5 MI. RADIUS



HOUSEHOLDS  
**5,887**  
5 MI. RADIUS



AVG. HOUSEHOLD INC.  
**\$73,566**  
5 MI. RADIUS

**TOK**  
COMMERCIAL



← **COEUR D'ALENE**  
34.1 MILES / 38 MIN

**SITE**

← **SILVER MOUNTAIN RESORT**  
2.8 MILES / 5 MIN

[ 9 ] **FORMER GROCERY OUTLET**

UPDATED: 5.21.2026 THIS PROPERTY IS EXCLUSIVELY MARKETED BY TOK BOISE LLC DBA TOK COMMERCIAL THIS INFORMATION WAS OBTAINED FROM SOURCES BELIEVED RELIABLE BUT CANNOT BE GUARANTEED. ANY OPINIONS OR ESTIMATES ARE USED FOR EXAMPLE ONLY.

**TOKCOMMERCIAL.COM**

Map data ©2025

# INCOME PRODUCING OWNER/USER OR INVESTMENT OPPORTUNITY

FOR SALE OR LEASE

20 NEARING WAY, SMELTERVILLE, ID 83868

**KRIS JACKSON**

208.449.1696 / [kris@tokcommercial.com](mailto:kris@tokcommercial.com)

**TOK** COMMERCIAL  
REAL ESTATE

