

**FOR SALE
OR LEASE**

**LIND AVE
INDUSTRIAL
CENTER**

23,121 SF TOTAL

865 LIND AVE SW
RENTON, WA



NEWMARK

TAYLOR HOFF, SIOR

Vice Chairman

425.362.1388

taylor.hoff@nmrk.com

THAD MALLORY, SIOR

Executive Vice Chairman

425.362.1410

thad.mallory@nmrk.com



BUILDING DETAILS

Address	865 Lind Ave SW Renton, WA
Parcel Number	192305-9030
Land Size	0.72 Acres (31,360 SF)
Rentable Area	23,121 SF
Office	2,783 SF
Clear Height	24'
Loading	2 Dock High Doors
Parking	26 Parking Stalls
Zoning	CA
Interior	Fully Insulated
Available	11/1/2026
Lease Rate	\$1.35 Blended, \$0.33 NNN
Sales Price	\$6,246,670

PROPERTY HIGHLIGHTS

- Rare standalone building strategically located in Renton, immediately adjacent to I-405 and proximate to I-5 & SR-167
- Meticulously maintained and functional relative to market with two dock high doors, 24' clear height, and partially temperature controlled warehouse space

FLOOR PLANS

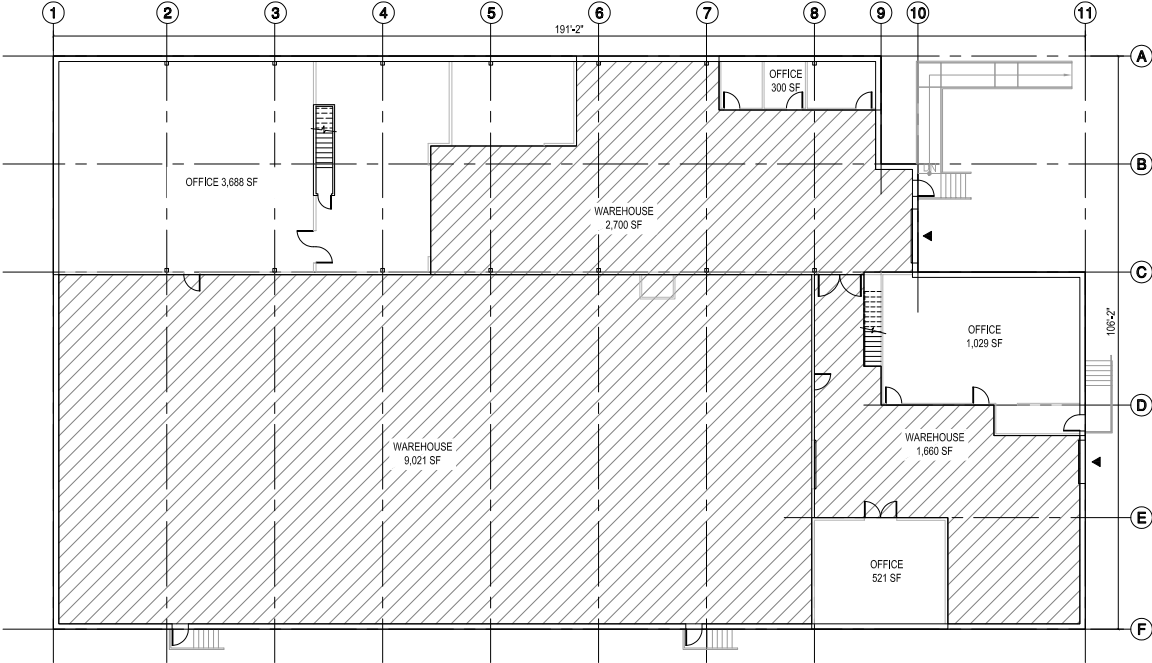

FIRST FLOOR

MEZZANINE

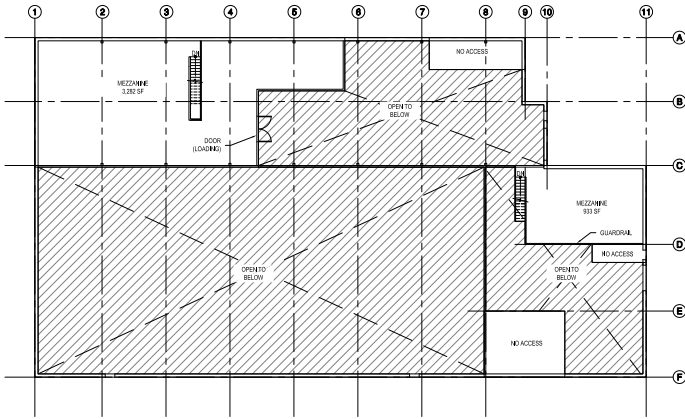

BUILDING LOCATION

SeaTac Airport	5 Miles
Port of Seattle	11 Miles
Port of Tacoma	24 Miles

**LIND AVENUE
INDUSTRIAL CENTER**
865 LIND AVE SW
RENTON, WA



LIND AVE INDUSTRIAL CENTER

865 LIND AVENUE SW
RENTON, WA

NEWMARK

TAYLOR HOFF, SIOR

Vice Chairman
425.362.1388
taylor.hoff@nrmk.com

THAD MALLORY, SIOR

Executive Vice Chairman
425.362.1410
thad.mallory@nrmk.com

The distributor of this communication is performing acts for which a real estate license is required. The information contained herein has been obtained from sources deemed reliable but has not been verified and no guarantee, warranty or representation, either express or implied, is made with respect to such information. Terms of sale or lease and availability are subject to change or withdrawal without notice. 18-1023