

# WHITE RIVER

## CORPORATE PARK BUILDING B

15,868 SF (1,066 SF OFFICE)

2302 WEST VALLEY HWY N, AUBURN, WA

SUITE 600

167

**NEWMARK**

*Owned and Managed by:*



**THAD MALLORY, SIOR**  
425.362.1410  
thad.mallory@nmrk.com

**CAM WARREN**  
425.362.1395  
cam.warren@nmrk.com

**TAYLOR HOFF, SIOR**  
425.362.1388  
taylor.hoff@nmrk.com

**BLAKE BENTZ**  
425.362.1391  
blake.bentz@nmrk.com

# AMENITIES/LOCATION MAP

WHITE RIVER CORPORATE PARK, BUILDING B



## ABOUT THE BUILDING

### Suite 600

- 15,868 SF (1,066 SF Office)
- 2 Grade Level Doors (One Oversized 22' x 16')
- 6 Dock High Doors
- 24' Clear Height
- \$1.05 Shell / \$1.35 Office, \$0.41 NNN
- Available 1/1/2027

### Property Highlights

- High image industrial park
- Excellent freeway visibility
- Great distribution or manufacturing space
- Immediate access to SR 167 & SR 18

# SITE & FLOOR PLAN

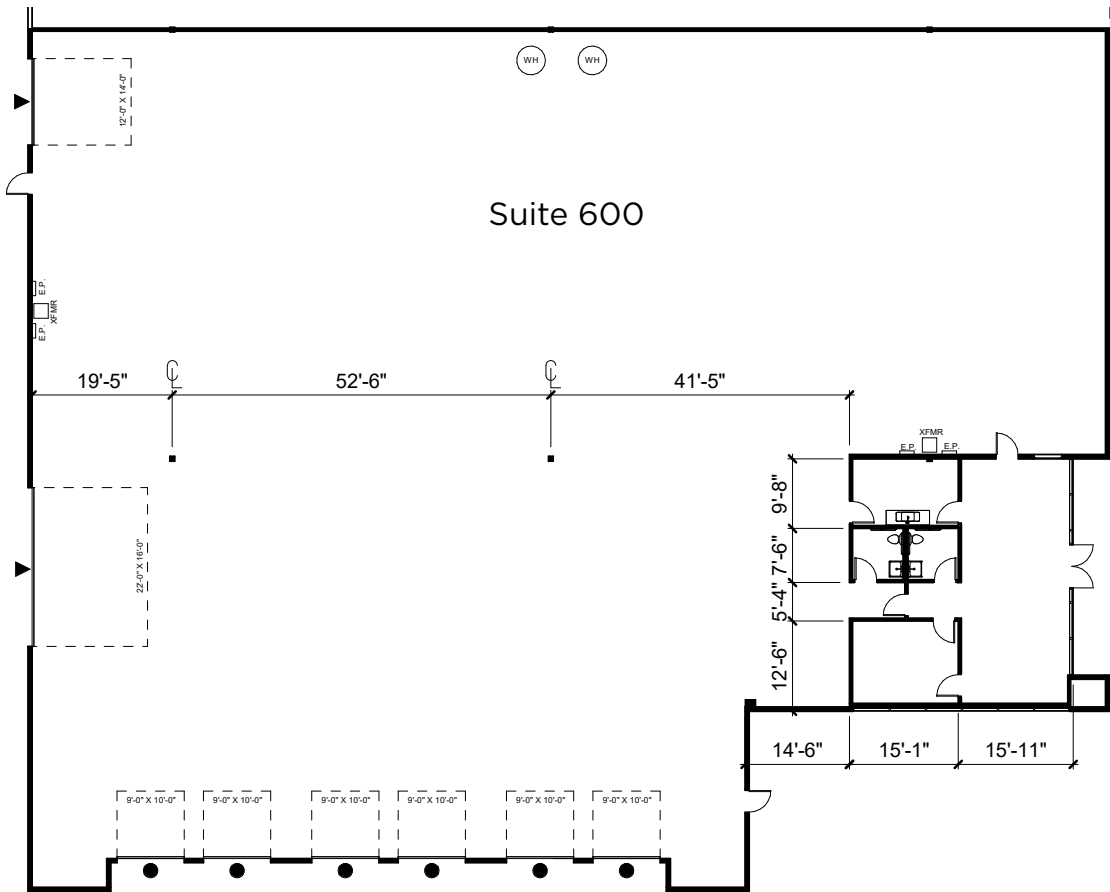
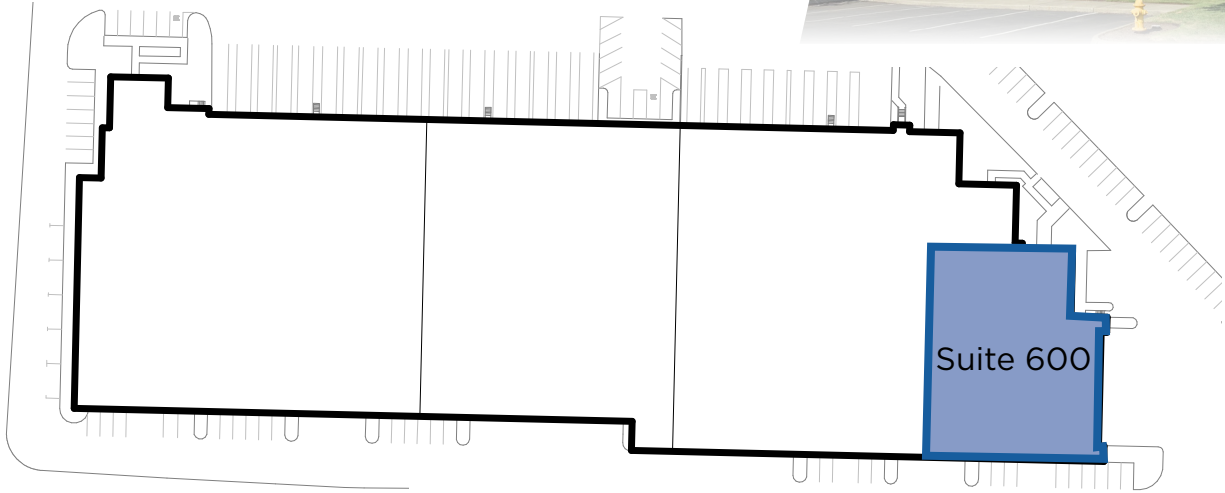

The information contained herein has been obtained from sources deemed reliable but has not been verified and no guarantee, warranty or representation, either express or implied, is made with respect to such information. Terms of sale or lease and availability are subject to change or withdrawal without notice.

**THAD MALLORY, SIOR**  
 425.362.1410  
[thad.mallory@nmrk.com](mailto:thad.mallory@nmrk.com)

**TAYLOR HOFF, SIOR**  
 425.362.1388  
[taylor.hoff@nmrk.com](mailto:taylor.hoff@nmrk.com)

**CAM WARREN**  
 425.362.1395  
[cam.warren@nmrk.com](mailto:cam.warren@nmrk.com)

**BLAKE BENTZ**  
 425.362.1391  
[blake.bentz@nmrk.com](mailto:blake.bentz@nmrk.com)

**NEWMARK**